



MANCHESTER-BY-THE-SEA

BOARD OF HEALTH

TOWN HALL - 10 CENTRAL STREET

Manchester-by-the-Sea, Massachusetts 01944-1399

Telephone (978) 526-7385

FAX (978) 526-2009

September 21, 2023

Vivek and Dana S. Menon
4 Hickory Hill Road
Manchester-by-the-Sea, MA 01944

NOTIFICATION TO OWNER

Upon receipt of the Title 5 Inspection Report for the onsite sewage disposal system at:

Property Address: **4 HICKORY HILL ROAD, MANCHESTER-BY-THE-SEA**

Property Owner: MENON, VIVEK and DANA S.

Licensed Title 5 Inspector: Michael DeCosta, Jr, Wind River Environmental SI# 13230

Title 5 Inspection Report dated 9/5/2023

The Board of Health DID NOT find the septic system, as it is now used, to constitute a danger to the public health and subsequently did not order its repair/replacement at this time.

Reviewing Board of Health Agent:

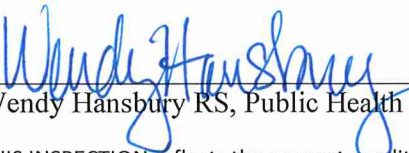
Wendy Hansbury RS, Public Health Director

THIS INSPECTION reflects the **present** condition of the sanitary disposal system and is not any guarantee as to the life or future condition of said system. A passing Title 5 Inspection Report with pump receipts for three years within each calendar year may be used for sale of property. (Explanation: If there is a potential that your home will be sold within three years, you **MUST** have the septic tank pumped once a year, within a year of the date of the approved Title 5 Inspection Report for each of the three years. This allows the sale to occur with the use of the pumping reports and annual receipts abates the need for a "Title 5 System Inspection" for a property transfer within three years of the passing inspection, otherwise a passing Title 5 Inspection Report is only good for two years.)



Commonwealth of Massachusetts

Title 5 Official Inspection Form

Subsurface Sewage Disposal System Form - Not for Voluntary Assessments

RECEIVED
pd CK315890
SEP 14 2023
\$135
BOARD OF HEALTH

4 Hickory Hill Road

Property Address

Vivek Menon and Dana S. Menon

Owner's Name

Manchester

MA

01944

Sep 5, 2023

City/Town

State

Zip Code

Date of Inspection

Owner
information is
required for every
page.

Inspection results must be submitted on this form. Inspection forms may not be altered in any way. Please see completeness checklist at the end of the form.

A. Inspector Information

1. Inspector:

Michael DeCosta JR

Name of Inspector

Wind River Environmental

Company Name

46 Lizotte Drive Suite 1000

Company Address

Marlborough

MA

01752

City/Town

State

Zip Code

508-400-8083

SI 13230

Telephone Number

License Number

B. Certification

I certify that: I am a DEP approved system inspector in full compliance with Section 15.340 of Title 5 (310 CMR 15.000); I have personally inspected the sewage disposal system at the property address listed above; the information reported below is true, accurate and complete as of the time of my inspection; and the inspection was performed based on my training and experience in the proper function and maintenance of on-site sewage disposal systems. After conducting this inspection I have determined that the system:

- ☒ Passes
☐ Conditionally Passes
☐ Needs Further Evaluation by the Local Approving Authority
☐ Fails

Michael DeCosta JR

Sep 5, 2023

Inspector's Signature

Date

The system inspector shall submit a copy of this inspection report to the Approving Authority (Board of Health or DEP) within 30 days of completing this inspection. If the system has a design flow of 10,000 gpd or greater, the inspector and the system owner shall submit the report to the appropriate regional office of the DEP. The original should be sent to the system owner and copies sent to the buyer, if applicable, and the approving authority.

Please note: This report only describes conditions at the time of inspection and under the conditions of use at that time. This inspection does not address how the system will perform in the future under the same or different conditions of use.



Commonwealth of Massachusetts

Title 5 Official Inspection Form

Subsurface Sewage Disposal System Form - Not for Voluntary Assessments

4 Hickory Hill Road

Property Address

Vivek Menon and Dana S. Menon

Owner's Name

Manchester

MA

01944

Sep 5, 2023

City/Town

State

Zip Code

Date of Inspection

Owner
information is
required for every
page.

C. Inspection summary

Inspection Summary: Complete 1, 2, 3, or 5 and all of 4 and 6.

1) System Passes:

- ☒ I have not found any information which indicates that any of the failure criteria described in 310 CMR 15.303 or in 310 CMR 15.304 exist. Any failure criteria not evaluated are indicated below.

Comments:

System functions as designed.

2) System Conditionally Passes:

- ☐ One or more system components as described in the "Conditional Pass" section need to be replaced or repaired. The system, upon completion of the replacement or repair, as approved by the Board of Health, will pass

Check the box for "yes", "no" or "not determined" (Y, N, ND) for the following statements. If "not determined," please explain.

The septic tank is metal and over 20 years old* or the septic tank (whether metal or not) is structurally unsound, exhibits substantial infiltration or exfiltration or tank failure is imminent. System will pass inspection if the existing tank is replaced with a complying septic tank as approved by the Board of Health.

* A metal septic tank will pass inspection if it is structurally sound, not leaking and if a Certificate of Compliance indicating that the tank is less than 20 years old is available.

- ☐ Y ☐ N ☐ ND (Explain below)



Commonwealth of Massachusetts

Title 5 Official Inspection Form

Subsurface Sewage Disposal System Form - Not for Voluntary Assessments

4 Hickory Hill Road

Property Address

Vivek Menon and Dana S. Menon

Owner's Name

Manchester

MA

01944

Sep 5, 2023

City/Town

State

Zip Code

Date of Inspection

Owner
information is
required for every
page.

C. Inspection summary (cont.)

2) System Conditionally Passes (cont.):

☐ Pump Chamber pumps/alarms not operational. System will pass with Board of Health approval if pumps/alarms are repaired.

☐ Observation of sewage backup or break out or high static water level in the distribution box due to broken or obstructed pipe(s) or due to a broken, settled or uneven distribution box. System will pass inspection if (with approval of Board of Health):

☐ broken pipe(s) are replaced

☐ Y

☐ N

☐ ND (Explain below):

☐ obstruction is removed

☐ Y

☐ N

☐ ND (Explain below):

☐ distribution box is leveled or replaced

☐ Y

☐ N

☐ ND (Explain below):

☐ The system required pumping more than 4 times a year due to broken or obstructed pipe(s). The system will pass inspection if (with approval of the Board of Health):

☐ broken pipe(s) are replaced

☐ Y

☐ N

☐ ND (Explain below):

☐ obstruction is removed

☐ Y

☐ N

☐ ND (Explain below):

3) Further Evaluation is Required by the Board of Health:

☐ Conditions exist which require further evaluation by the Board of Health in order to determine if the system is failing to protect public health, safety or the environment.

a. System will pass unless Board of Health determines in accordance with 310 CMR 15.303(1)(b) that the system is not functioning in a manner which will protect public health, safety and the environment:



Commonwealth of Massachusetts

Title 5 Official Inspection Form

Subsurface Sewage Disposal System Form - Not for Voluntary Assessments

4 Hickory Hill Road

Property Address

Vivek Menon and Dana S. Menon

Owner's Name

Manchester

MA

01944

Sep 5, 2023

City/Town

State

Zip Code

Date of Inspection

Owner
information is
required for every
page.

C. Inspection summary (cont.)

☐ Cesspool or privy is within 50 feet of a surface water

☐ Cesspool or privy is within 50 feet of a bordering vegetated wetland or a salt marsh

b. System will fail unless the Board of Health (and Public Water Supplier, if any) determines that the system is functioning in a manner that protects the public health, safety and environment:

☐ The system has a septic tank and soil absorption system (SAS) and the SAS is within 100 feet of a surface water supply or tributary to a surface water supply.

☐ The system has a septic tank and SAS and the SAS is within a Zone 1 of a public water supply.

☐ The system has a septic tank and SAS and the SAS is within 50 feet of a private water supply well.

☐ The system has a septic tank and SAS and the SAS is less than 100 feet but 50 feet or more from a private water supply well**.

Method used to determine distance: _____

** This system passes if the well water analysis, performed at a DEP certified laboratory, for fecal coliform bacteria indicates absent and the presence of ammonia nitrogen and nitrate nitrogen is equal to or less than 5 ppm, provided that no other failure criteria are triggered. A copy of the analysis must be attached to this form.

c. Other:

4) System Failure Criteria Applicable to All Systems:

You must indicate "Yes" or "No" to each of the following for all inspections:

Yes

No

☐☒

Backup of sewage into facility or system component due to overloaded or clogged SAS or cesspool

☐☒

Discharge or ponding of effluent to the surface of the ground or surface waters due to an overloaded or clogged SAS or cesspool



Commonwealth of Massachusetts

Title 5 Official Inspection Form

Subsurface Sewage Disposal System Form - Not for Voluntary Assessments

4 Hickory Hill Road

Property Address

Vivek Menon and Dana S. Menon

Owner's Name

Manchester

MA

01944

Sep 5, 2023

City/Town

State

Zip Code

Date of Inspection

Owner information is required for every page.

C. Inspection summary (cont.)

4) System Failure Criteria Applicable to All Systems: (cont.)

- | Yes | No | |
|--------------------------|-------------------------------------|---|
| <input type="checkbox"/> | <input checked="" type="checkbox"/> | Static liquid level in the distribution box above outlet invert due to an overloaded or clogged SAS or cesspool |
| <input type="checkbox"/> | <input checked="" type="checkbox"/> | Liquid depth in cesspool is less than 6" below invert or available volume is less than ½ day flow |
| <input type="checkbox"/> | <input checked="" type="checkbox"/> | Required pumping more than 4 times in the last year NOT due to clogged or obstructed pipe(s). Number of times pumped: __ |
| <input type="checkbox"/> | <input checked="" type="checkbox"/> | Any portion of the SAS, cesspool or privy is below high ground water elevation. |
| <input type="checkbox"/> | <input checked="" type="checkbox"/> | Any portion of cesspool or privy is within 100 feet of a surface water supply or tributary to a surface water supply. |
| <input type="checkbox"/> | <input checked="" type="checkbox"/> | Any portion of a cesspool or privy is within a Zone 1 of a public well. |
| <input type="checkbox"/> | <input checked="" type="checkbox"/> | Any portion of a cesspool or privy is within 50 feet of a private water supply well. |
| <input type="checkbox"/> | <input checked="" type="checkbox"/> | Any portion of a cesspool or privy is less than 100 feet but greater than 50 feet from a private water supply well with no acceptable water quality analysis. [This system passes if the well water analysis, performed at a DEP certified laboratory, for fecal coliform bacteria indicates absent and the presence of ammonia nitrogen and nitrate nitrogen is equal to or less than 5 ppm, provided that no other failure criteria are triggered. A copy of the analysis and chain of custody must be attached to this form.] |
| <input type="checkbox"/> | <input checked="" type="checkbox"/> | The system is a cesspool serving a facility with a design flow of 2000gpd-10,000gpd. |
| <input type="checkbox"/> | <input checked="" type="checkbox"/> | The system fails. I have determined that one or more of the above failure criteria exist as described in 310 CMR 15.303, therefore the system fails. The system owner should contact the Board of Health to determine what will be necessary to correct the failure. |

5) Large Systems: To be considered a large system the system must serve a facility with a design flow of 10,000 gpd to 15,000 gpd.

For large systems, you must indicate either "yes" or "no" to each of the following, in addition to the questions in Section C.4.

- | Yes | No | |
|--------------------------|--------------------------|--|
| <input type="checkbox"/> | <input type="checkbox"/> | the system is within 400 feet of a surface drinking water supply |
| <input type="checkbox"/> | <input type="checkbox"/> | the system is within 200 feet of a tributary to a surface drinking water supply |
| <input type="checkbox"/> | <input type="checkbox"/> | the system is located in a nitrogen sensitive area (Interim Wellhead Protection Area - IWPA) or a mapped Zone II of a public water supply well |

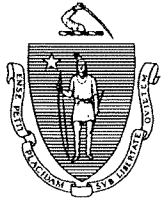

Title 5 Official Inspection Form

Subsurface Sewage Disposal System Form - Not for Voluntary Assessments

4 Hickory Hill Road

Property Address

Vivek Menon and Dana S. Menon

Owner's Name

Manchester

MA

01944

Sep 5, 2023

City/Town

State

Zip Code

Date of Inspection

Owner
information is
required for every
page.

C. Inspection summary (cont.)

If you have answered "yes" to any question in Section C.5 the system is considered a significant threat, or answered "yes" in Section C.4 above the large system has failed. The owner or operator of any large system considered a significant threat under Section C.5 or failed under Section C.4 shall upgrade the system in accordance with 310 CMR 15.304. The system owner should contact the appropriate regional office of the Department.

6. You must indicate "yes" or "no" for each of the following for *all* inspections:

- | Yes | No | |
|-------------------------------------|-------------------------------------|--|
| <input checked="" type="checkbox"/> | <input type="checkbox"/> | Pumping information was provided by the owner, occupant, or Board of Health |
| <input type="checkbox"/> | <input checked="" type="checkbox"/> | Were any of the system components pumped out in the previous two weeks? |
| <input checked="" type="checkbox"/> | <input type="checkbox"/> | Has the system received normal flows in the previous two week period? |
| <input type="checkbox"/> | <input checked="" type="checkbox"/> | Have large volumes of water been introduced to the system recently or as part of this inspection? |
| <input checked="" type="checkbox"/> | <input type="checkbox"/> | Were as built plans of the system obtained and examined? (If they were not available note as N/A) |
| <input checked="" type="checkbox"/> | <input type="checkbox"/> | Was the facility or dwelling inspected for signs of sewage back up? |
| <input checked="" type="checkbox"/> | <input type="checkbox"/> | Was the site inspected for signs of break out? |
| <input checked="" type="checkbox"/> | <input type="checkbox"/> | Were all system components, excluding the SAS, located on site? |
| <input checked="" type="checkbox"/> | <input type="checkbox"/> | Were the septic tank manholes uncovered, opened, and the interior of the tank inspected for the condition of the baffles or tees, material of construction, dimensions, depth of liquid, depth of sludge and depth of scum? |
| <input checked="" type="checkbox"/> | <input type="checkbox"/> | Was the facility owner (and occupants if different from owner) provided with information on the proper maintenance of subsurface sewage disposal systems? The size and location of the Soil Absorption System (SAS) on the site has been determined based on: |
| <input checked="" type="checkbox"/> | <input type="checkbox"/> | Existing information. For example, a plan at the Board of Health. |
| <input type="checkbox"/> | <input checked="" type="checkbox"/> | Determined in the field (if any of the failure criteria related to Part C is at issue approximation of distance is unacceptable) [310 CMR 15.302(5)] |

**Title 5 Official Inspection Form****Subsurface Sewage Disposal System Form - Not for Voluntary Assessments**

4 Hickory Hill Road

Property Address

Vivek Menon and Dana S. Menon

Owner's Name

Manchester

MA

01944

Sep 5, 2023

City/Town

State

Zip Code

Date of Inspection

Owner
information is
required for every
page.**D. System Information****1. Residential Flow Conditions:**

Number of bedrooms (design): 4 Number of bedrooms (actual): 4

DESIGN flow based on 310 CMR 15.203 (for example: 110 gpd x # of bedrooms): 440

Description:

Number of current residents: 4

Does residence have a garbage grinder? ☐ Yes ☒ NoDoes residence have a water treatment unit? ☐ Yes ☒ No

If yes, discharges to:

Is laundry on a separate sewage system? (Include laundry system inspection information in this report.) ☐ Yes ☒ NoLaundry system inspected? ☐ Yes ☒ NoSeasonal use? ☐ Yes ☒ No

Water meter readings, if available (last 2 years usage (gpd)): 116 gpd

Detail:

Two year water usage: $11,300 \text{ CF} \times 7.5 = 84,750 \text{ gallons} / 739 \text{ days} = 116 \text{ gpd}$. Water use records from the town are attached on Page 18.Sump pump? ☒ Yes ☐ NoLast date of occupancy: Currently occupied
Date

**Title 5 Official Inspection Form****Subsurface Sewage Disposal System Form - Not for Voluntary Assessments**

4 Hickory Hill Road

Property Address

Vivek Menon and Dana S. Menon

Owner's Name

Manchester

MA

01944

Sep 5, 2023

City/Town

State

Zip Code

Date of Inspection

Owner
information is
required for every
page.**D. System Information (cont.)****2. Commercial/Industrial Flow Conditions:**

Type of Establishment: _____

Design flow (based on 310 CMR 15.203): _____

Gallons per day (gpd) _____

Basis of design flow (seats/persons/sq.ft., etc.): _____

Grease trap present?

☐ Yes☐ No

Water treatment unit present?

☐ Yes☐ No

If yes, discharges to _____

Industrial waste holding tank present?

☐ Yes☐ No

Non-sanitary waste discharged to the Title 5 system?

☐ Yes☐ No

Water meter readings, if available: _____

Last date of occupancy/use: _____

Date

Other (describe below):

_____**General Information****3. Pumping Records:**

Source of information:

The homeowner and Wind River Environmental are the sources of the information.

Was system pumped as part of the inspection?

☒

Yes

☐

No

If yes, volume pumped:

1500

gallons

How was quantity pumped determined?

Quantity measured by pump truck

Reason for pumping:

Check structural integrity of the tank



Commonwealth of Massachusetts

Title 5 Official Inspection Form

Subsurface Sewage Disposal System Form - Not for Voluntary Assessments

4 Hickory Hill Road

Property Address

Vivek Menon and Dana S. Menon

Owner's Name

Manchester

MA

01944

Sep 5, 2023

City/Town

State

Zip Code

Date of Inspection

Owner
information is
required for every
page.

D. System Information (cont.)

4. Type of System:

- ☒ Septic tank, distribution box, soil absorption system
- ☐ Single cesspool
- ☐ Overflow cesspool
- ☐ Privy
- ☐ Shared system (yes or no) (if yes, attach previous inspection records, if any)
- ☐ Innovative/Alternative technology. Attach a copy of the current operation and maintenance contract (to be obtained from system owner) and a copy of latest inspection of the I/A system by system operator under contract
- ☐ Tight tank. Attach a copy of the DEP approval.
- ☐ Other (describe):

Approximate age of all components, date installed (if known) and source of information:

1968 per disposal works permit

Were sewage odors detected when arriving at the site?

☐ Yes

☒ No

5. Building Sewer (locate on site plan):

Depth below grade:

1.6

feet

Material of construction:

☒ cast iron ☐ 40 PVC ☐ other (explain):

Distance from private water supply well or suction line:

N/A

feet

Comments (on condition of joints, venting, evidence of leakage, etc.):

All joints are sealed. No leaks.



Title 5 Official Inspection Form

Subsurface Sewage Disposal System Form - Not for Voluntary Assessments

4 Hickory Hill Road

Property Address

Vivek Menon and Dana S. Menon

Owner's Name

Manchester

MA

01944

Sep 5, 2023

City/Town

State

Zip Code

Date of Inspection

Owner
information is
required for every
page.

D. System Information (cont.)

6. Septic Tank (locate on site plan):

Depth below grade:

0.08

feet

Material of construction:



concrete



metal



fiberglass



polyethylene



other (explain)

If tank is metal, list age:

years

Is age confirmed by a Certificate of Compliance? (attach a copy of certificate)



Yes



No

Dimensions:

10' x 5' x 5'

Sludge depth:

4"

Distance from top of sludge to bottom of outlet tee or baffle

38"

Scum thickness

6"

Distance from top of scum to top of outlet tee or baffle

6"

Distance from bottom of scum to bottom of outlet tee or baffle

15"

How were dimensions determined?

Tape measure

Comments (on pumping recommendations, inlet and outlet tee or baffle condition, structural integrity, liquid levels as related to outlet invert, evidence of leakage, etc.):

Center and outlet covers are on risers to grade. Tees are good. Outlet has filter installed. Liquid level is normal with moderate solids and sludge. Tank appears to be structurally sound and not leaking. Recommend pumping tank and cleaning filter annually.



Commonwealth of Massachusetts

Title 5 Official Inspection Form

Subsurface Sewage Disposal System Form - Not for Voluntary Assessments

4 Hickory Hill Road

Property Address

Vivek Menon and Dana S. Menon

Owner's Name

Manchester

MA

State

01944

Zip Code

Sep 5, 2023

Date of Inspection

Owner
information is
required for every
page.

D. System Information (cont.)

7. Grease Trap (locate on site plan):

Depth below grade:

_____ feet

Material of construction:

☐ concrete

☐ metal

☐ fiberglass

☐ polyethylene

☐ other (explain):

Dimensions:

Scum thickness

Distance from top of scum to top of outlet tee or baffle

Distance from bottom of scum to bottom of outlet tee or baffle

Date of last pumping:

_____ Date

Comments (on pumping recommendations, inlet and outlet tee or baffle condition, structural integrity, liquid levels as related to outlet invert, evidence of leakage, etc.):

8. Tight or Holding Tank (tank must be pumped at time of inspection) (locate on site plan):

Depth below grade:

Material of construction:

☐ concrete

☐ metal

☐ fiberglass

☐ polyethylene

☐ other (explain):

Dimensions:

Capacity:

_____ gallons

Design Flow:

_____ gallons per day



Title 5 Official Inspection Form

Subsurface Sewage Disposal System Form - Not for Voluntary Assessments

4 Hickory Hill Road

Property Address

Vivek Menon and Dana S. Menon

Owner's Name

Manchester

MA

State

01944

Zip Code

Sep 5, 2023

Date of Inspection

Owner
information is
required for every
page.

D. System Information (cont.)

8. Tight or Holding Tank (cont.)

Alarm present:

☐ Yes ☐ No

Alarm level: ____

Alarm in working order: ☐ Yes ☐ No

Date of last pumping:

Date

Comments (condition of alarm and float switches, etc.):

* Attach copy of current pumping contract (required). Is copy attached? ☐ Yes ☐ No

9. Distribution Box (if present must be opened) (locate on site plan):

Depth of liquid level above outlet invert

0

Comments (note if box is level and distribution to outlets equal, any evidence of solids carryover, any evidence of leakage into or out of box, etc.):

Distribution box is on riser cover 8" below grade. Box size 16"x20". Box has four outlets with Speed Levelers installed to ensure equal distribution. Liquid level is normal. Minimal carryover into box. Box is in good condition, watertight, and not leaking.



Commonwealth of Massachusetts

Title 5 Official Inspection Form

Subsurface Sewage Disposal System Form - Not for Voluntary Assessments

4 Hickory Hill Road

Property Address

Vivek Menon and Dana S. Menon

Owner's Name

Manchester

MA

01944

Sep 5, 2023

City/Town

State

Zip Code

Date of Inspection

Owner
information is
required for every
page.

D. System Information (cont.)

10. Pump Chamber (locate on site plan):

Pumps in working order:

☐ Yes ☐ No*

Alarms in working order:

☐ Yes ☐ No*

Comments (note condition of pump chamber, condition of pumps and appurtenances, etc.):

* If pumps or alarms are not in working order, system is a conditional pass.

11. Soil Absorption System (SAS) (locate on site plan, excavation not required):

If SAS not located, explain why:

Type:

- ☐ leaching pits
☐ leaching chambers
☐ leaching galleries
☐ leaching trenches
☒ leaching fields
☐ overflow cesspool
☐ innovative/alternative system

number:

number:

number:

number, length:

number, dimensions: 1, 25'x31'

number:

Type/name of technology:



Commonwealth of Massachusetts

Title 5 Official Inspection Form

Subsurface Sewage Disposal System Form - Not for Voluntary Assessments

4 Hickory Hill Road

Property Address

Vivek Menon and Dana S. Menon

Owner's Name

Manchester

MA

State

01944

Zip Code

Sep 5, 2023

Date of Inspection

Owner
information is
required for every
page.

D. System Information (cont.)

11. Soil Absorption System (SAS)(Cont.)

Comments (note condition of soil, signs of hydraulic failure, level of ponding, damp soil, condition of vegetation, etc.):

Dry, compact soil. No ponding. Showing no signs of hydraulic failure. Vegetation is normal.

12. Cesspools (cesspool must be pumped as part of inspection) (locate on site plan):

Number and configuration

Depth - top of liquid to inlet invert

Depth of solids layer

Depth of scum layer

Dimensions of cesspool

Materials of construction

Indication of groundwater inflow

☐ Yes ☐ No

Comments (note condition of soil, signs of hydraulic failure, level of ponding, condition of vegetation, etc.):



Commonwealth of Massachusetts

Title 5 Official Inspection Form

Subsurface Sewage Disposal System Form - Not for Voluntary Assessments

4 Hickory Hill Road

Property Address

Vivek Menon and Dana S. Menon

Owner's Name

Manchester

MA

01944

Sep 5, 2023

City/Town

State

Zip Code

Date of Inspection

Owner
information is
required for every
page.

D. System Information (cont.)

13. Privy (locate on site plan):

Materials of construction:

Dimensions

Depth of solids

Comments (note condition of soil, signs of hydraulic failure, level of ponding, condition of vegetation, etc.):



Commonwealth of Massachusetts

Title 5 Official Inspection Form

Subsurface Sewage Disposal System Form - Not for Voluntary Assessments

4 Hickory Hill Road

Property Address

Vivek Menon and Dana S. Menon

Owner's Name

Manchester

MA

01944

Sep 5, 2023

City/Town

State

Zip Code

Date of Inspection

Owner information is required for every page.

D. System Information (cont.)

14. Sketch Of Sewage Disposal System:

Provide a view of the sewage disposal system, including ties to at least two permanent reference landmarks or benchmarks. Locate all wells within 100 feet. Locate where public water supply enters the building. Check one of the boxes below:

- ☒ hand-sketch in the area below
☐ drawing attached separately

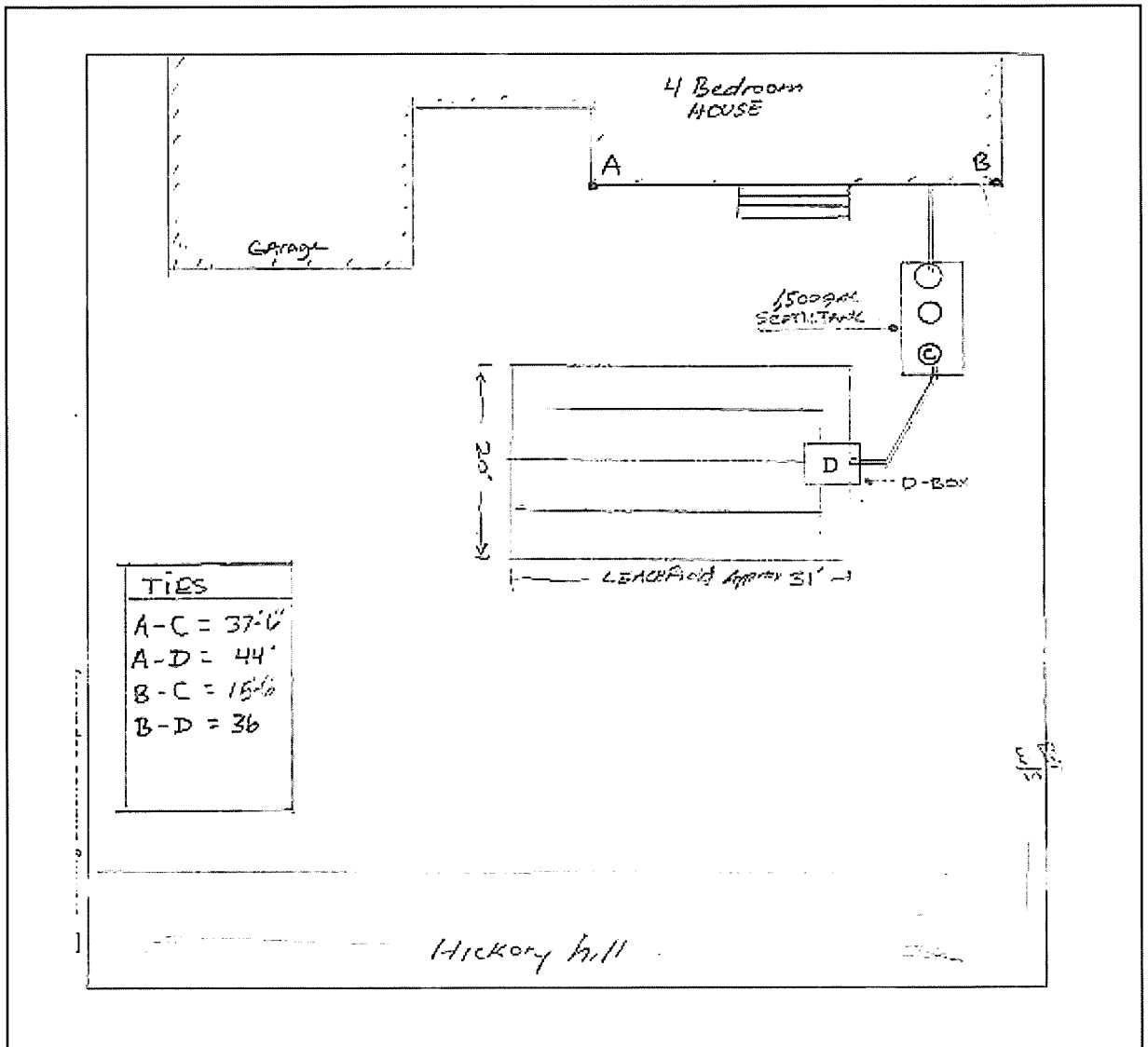



Commonwealth of Massachusetts

Title 5 Official Inspection Form

Subsurface Sewage Disposal System Form - Not for Voluntary Assessments

4 Hickory Hill Road

Property Address

Vivek Menon and Dana S. Menon

Owner's Name

Manchester

MA

01944

Sep 5, 2023

City/Town

State

Zip Code

Date of Inspection

Owner
information is
required for every
page.

D. System Information (cont.)

15. Site Exam:

- ☒ Check Slope
- ☒ Surface water
- ☒ Check cellar
- ☒ Shallow wells

Estimated depth to high ground water:

6'+

feet

Please indicate all methods used to determine the high ground water elevation:

☐

Obtained from system design plans on record

If checked, date of design plan reviewed:

Date

☒

Observed site (abutting property/observation hole within 150 feet of SAS)

☐

Checked with local Board of Health - explain:

☐

Checked with local excavators, installers - (attach documentation)

☐

Accessed USGS database - explain:

You **must** describe how you established the high ground water elevation:

Hand augured small hole off side of leaching area. Hole was 6' below grade with no indication of groundwater.

Bottom of SAS is 36" below grade.

Before filing this Inspection Report, please see Report Completeness Checklist on next page.



Subsurface Sewage Disposal System Form - Not for Voluntary Assessments

4 Hickory Hill Road

Property Address

Vivek Menon and Dana S. Menon

Owner's Name

Manchester

MA

01944

Sep 5, 2023

City/Town

State

Zip Code

Date of Inspection

Owner information is required for every page.

Complete all applicable sections of this form inclusive of:

- ☒ A. Inspection information: Complete all fields in this section.
- ☒ B. Certification: Signed & Dated and 1, 2, 3, or 4 checked
- ☒ C. Inspection Summary:
 - 1, 2, 3, or 5 completed as appropriate
 - 4 (Failure Criteria) and 6 (Checklist) completed
- ☒ D. System Information:
 - For 8: Tight/Holding Tank - Pumping contract attached
 - For 15: Sketch of Sewage Disposal System drawn on pg. 16 or attached
 - For 16: Explanation of estimated depth to high groundwater included

Water Use Records

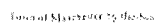

Customer Transaction Summary

Customer Information

Received Nov. 2004
 Accepted March 2005
 Copyright © 2005 Society for Neuroscience
 0270-6474/05/251111-11\$15.00/0

Location Information

THE UNIVERSITY OF CHICAGO
 1100 SOUTH MICHIGAN
 CHICAGO, ILL. 60607

Year	Type	Max Sale	Ranking	Group	Sub-Category	Frequency Annual	Balance
09/06/2019	Charge	3114.7504	2834	1	0000	90.50	21.58
09/12/2019	Payment	1.50000000				-90.50	-21.58
09/13/2019	Charge	373.931000	2820	1	0000	3.00	178.41
09/21/2019	Charge	3.00000000				3.00	-175.41
11/11/2019	Charge	15.00000000	2554	1	0000	100.00	158.13
12/06/2019	Charge	1.00000000				100.00	-158.13
09/15/2019	Charge	3100.0000	3470	1	0000	153.50	153.63
09/30/2019	Payment					-153.63	-153.63
09/30/2019	Charge					153.63	0.00
09/09/2019	Payment	1.00000000				-155.35	-155.35
09/15/2019	Charge	34.30000000	3584	0	0000	100.50	107.59
09/20/2019	Payment	1.50000000				-107.59	-107.59
09/15/2019	Charge	37.12000000	3598	1	0000	3.00	96.14
09/10/2019	Payment	1.00000000				-96.14	-96.14
11/15/2019	Charge	3150.0000	4342	1	2000	12.00	123.65
11/15/2019	Payment					-123.65	-123.65
09/15/2019	Charge	3100.0000	4348	1	0000	100.00	100.00
09/05/2019	Charge	1.50000000				100.00	-100.00
09/15/2019	Charge	21.00000000	4348	1	0000	3.00	100.00
09/06/2019	Payment	1.50000000				-100.00	-100.00
09/17/2019	Charge	31.15000000	4358	1	2000	3.00	127.15
09/24/2019	Payment	1.50000000				-127.15	-127.15
11/06/2019	Charge	3100.0000	4376	1	0000	9.00	127.15
11/23/2019	Payment	1.50000000				-127.15	-127.15
09/06/2019	Charge	31.07000000	4376	1	0000	100.00	100.00
09/16/2019	Payment	1.50000000				-100.00	-100.00
09/16/2019	Charge	31.00000000	4377	1	0000	100.00	100.00
09/17/2019	Payment	1.50000000				-100.00	-100.00
09/16/2019	Charge	31.00000000	4377	1	0000	100.00	100.00
09/17/2019	Payment	1.50000000				-100.00	-100.00
09/16/2019	Charge	31.00000000	4377	1	0000	100.00	100.00
09/17/2019	Payment	1.50000000				-100.00	-100.00
09/16/2019	Charge	31.00000000	4377	1	0000	100.00	100.00
09/17/2019	Payment	1.50000000				-100.00	-100.00
09/16/2019	Charge	31.00000000	4377	1	0000	100.00	100.00
09/17/2019	Payment	1.50000000				-100.00	-100.00
09/16/2019	Charge	31.00000000	4377	1	0000	100.00	100.00
09/17/2019	Payment	1.50000000				-100.00	-100.00
09/16/2019	Charge	31.00000000	4377	1	0000	100.00	100.00
09/17/2019	Payment	1.50000000				-100.00	-100.00
09/16/2019	Charge	31.00000000	4377	1	0000	100.00	100.00
09/17/2019	Payment	1.50000000				-100.00	-100.00
09/16/2019	Charge	31.00000000	4377	1	0000	100.00	100.00
09/17/2019	Payment	1.50000000				-100.00	-100.00
09/16/2019	Charge	31.00000000	4377	1	0000	100.00	100.00
09/17/2019	Payment	1.50000000				-100.00	-100.00
09/16/2019	Charge	31.00000000	4377	1	0000	100.00	100.00
09/17/2019	Payment	1.50000000				-100.00	-100.00
09/16/2019	Charge	31.00000000	4377	1	0000	100.00	100.00
09/17/2019	Payment	1.50000000				-100.00	-100.00
09/16/2019	Charge	31.00000000	4377	1	0000	100.00	100.00
09/17/2019	Payment	1.50000000				-100.00	-100.00
09/16/2019	Charge	31.00000000	4377	1	0000	100.00	100.00
09/17/2019	Payment	1.50000000				-100.00	-100.00
09/16/2019	Charge	31.00000000	4377	1	0000	100.00	100.00
09/17/2019	Payment	1.50000000				-100.00	-100.00
09/16/2019	Charge	31.00000000	4377	1	0000	100.00	100.00
09/17/2019	Payment	1.50000000				-100.00	-100.00
09/16/2019	Charge	31.00000000	4377	1	0000	100.00	100.00
09/17/2019	Payment	1.50000000				-100.00	-100.00
09/16/2019	Charge	31.00000000	4377	1	0000	100.00	100.00
09/17/2019	Payment	1.50000000				-100.00	-100.00
09/16/2019	Charge	31.00000000	4377	1	0000	100.00	100.00
09/17/2019	Payment	1.50000000				-100.00	-100.00
09/16/2019	Charge	31.00000000	4377	1	0000	100.00	100.00
09/17/2019	Payment	1.50000000				-100.00	-100.00
09/16/2019	Charge	31.00000000	4377	1	0000	100.00	100.00
09/17/2019	Payment	1.50000000				-100.00	-100.00
09/16/2019	Charge	31.00000000	4377	1	0000	100.00	100.00
09/17/2019	Payment	1.50000000				-100.00	-100.00
09/16/2019	Charge	31.00000000	4377	1	0000	100.00	100.00
09/17/2019	Payment	1.50000000				-100.00	-100.00
09/16/2019	Charge	31.00000000	4377	1	0000	100.00	100.00
09/17/2019	Payment	1.50000000				-100.00	-100.00
09/16/2019	Charge	31.00000000	4377	1	0000	100.00	100.00
09/17/2019	Payment	1.50000000				-100.00	-100.00
09/16/2019	Charge	31.00000000	4377	1	0000	100.00	100.00
09/17/2019	Payment	1.50000000				-100.00	-100.00
09/16/2019	Charge	31.00000000	4377	1	0000	100.00	100.00
09/17/2019	Payment	1.50000000				-100.00	-100.00
09/16/2019	Charge	31.00000000	4377	1	0000	100.00	100.00
09/17/2019	Payment	1.50000000				-100.00	-100.00
09/16/2019	Charge	31.00000000	4377	1	0000	100.00	100.00
09/17/2019	Payment	1.50000000				-100.00	-100.00
09/16/2019	Charge	31.00000000	4377	1	0000	100.00	100.00
09/17/2019	Payment	1.50000000				-100.00	-100.00
09/16/2019	Charge	31.00000000	4377	1	0000	100.00	100.00
09/17/2019	Payment	1.50000000				-100.00	-100.00
09/16/2019	Charge	31.00000000	4377	1	0000	100.00	100.00
09/17/2019	Payment	1.50000000				-100.00	-100.00
09/16/2019	Charge	31.00000000	4377	1	0000	100.00	100.00
09/17/2019	Payment	1.50000000				-100.00	-100.00
09/16/2019	Charge	31.00000000	4377	1	0000	100.00	100.00
09/17/2019	Payment	1.50000000				-100.00	-100.00
09/16/2019	Charge	31.00000000	4377	1	0000	100.00	100.00
09/17/2019	Payment	1.50000000				-100.00	-100.00
09/16/2019	Charge	31.00000000	4377	1	0000	100.00	100.00
09/17/2019	Payment	1.50000000				-100.00	-100.00
09/16/2019	Charge	31.00000000	4377	1	0000	100.00	100.00
09/17/2019	Payment	1.50000000				-100.00	-100.00
09/16/2019	Charge	31.00000000	4377	1	0000	100.00	100.00
09/17/2019	Payment	1.50000000				-100.00	-100.00
09/16/2019	Charge	31.00000000	4377	1	0000	100.00	100.00
09/17/2019	Payment	1.50000000				-100.00	-100.00
09/16/2019	Charge	31.00000000	4377	1	0000	100.00	100.00
09/17/2019	Payment	1.50000000				-100.00	-100.00
09/16/2019	Charge	31.00000000	4377	1	0000	100.00	100.00
09/17/2019	Payment	1.50000000				-100.00	-100.00
09/16/2019	Charge	31.00000000	4377	1	0000	100.00	100.00
09/17/2019	Payment	1.50000000				-100.00	-100.00
09/16/2019	Charge	31.00000000	4377	1	0000	100.00	100.00
09/17/2019	Payment	1.50000000				-100.00	-100.00
09/16/2019	Charge	31.00000000	4377	1	0000	100.00	100.00
09/17/2019	Payment	1.50000000				-100.00	-100.00
09/16/2019	Charge	31.00000000	4377	1	0000	100.00	100.00
09/17/2019	Payment	1.50000000				-100.00	-100.00
09/16/2019	Charge	31.00000000	4377	1	0000	100.00	100.00
09/17/2019	Payment	1.50000000				-100.00	-100.00
09/16/2019	Charge	31.00000000	4377	1	0000	100.00	100.00
09/17/2019	Payment	1.50000000				-100.00	-100.00
09/16/2019	Charge	31.00000000	4377	1	0000	100.00	100.00
09/17/2019	Payment	1.50000000				-100.00	-100.00
09/16/2019	Charge	31.00000000	4377	1	0000	100.00	100.00
09/17/2019	Payment	1.50000000				-100.00	-100.00
09/16/2019	Charge	31.00000000	4377	1	0000	100.00	100.00
09/17/2019	Payment	1.50000000				-100.00	-100.00
09/16/2019	Charge	31.00000000	4377	1	0000	100.00	100.00
09/17/2019	Payment	1.50000000				-100.00	-100.00
09/16/2019	Charge	31.00000000	4377	1	0000	100.00	100.00
09/17/2019	Payment	1.50000000				-100.00	-100.00
09/16/2019	Charge	31.00000000	4377	1	0000	100.00	100.00
09/17/2019	Payment	1.50000000				-100.00	-100.00
09/16/2019	Charge	31.00000000	4377	1	0000	100.00	100.00
09/17/2019	Payment	1.50000000				-100.00	-100.00
09/16/2019	Charge	31.00000000	4377	1	0000	100.00	100.00
09/17/2019	Payment	1.50000000				-100.00	-100.00
09/16/2019	Charge	31.00000000	4377	1	0000	100.00	100.00
09/17/2019	Payment	1.50000000				-100.00	-100.00
09/16/2019	Charge	31.00000000	4377	1	0000	100.00	100.00
09/17/2019	Payment	1.50000000				-100.00	-100.00
09/16/2019	Charge	31.00000000	4377	1	0000	100.00	100.00
09/17/2019	Payment	1.50000000				-100.00	-100.00
09/16/2019	Charge	31.00000000	4377	1	0000	100.00	100.00
09/17/2019	Payment	1.50000000				-100.00	-100.00
09/16/2019	Charge	31.00000000	4377	1	0000	100.00	100.00
09/17/2019	Payment	1.50000000				-100.00	-100.00
09/16/2019	Charge	31.00000000	4377	1	0000	100.00	100.00
09/17/2019	Payment	1.50000000				-100.00	-100.00
09/16/2019	Charge	31.00000000	4377	1	0000	100.00	100.00
09/17/2019	Payment	1.50000000				-100.00	-100.00
09/16/2019	Charge	31.00000000	4377	1	0000	100.00	100.00
09/17/2019	Payment	1.50000000				-100.00	-100.00
09/16/2019	Charge	31.00000000	4377	1	0000	100.00	100.00
09/17/2019	Payment	1.50000000				-100.00	-100.00
09							

[illegible]